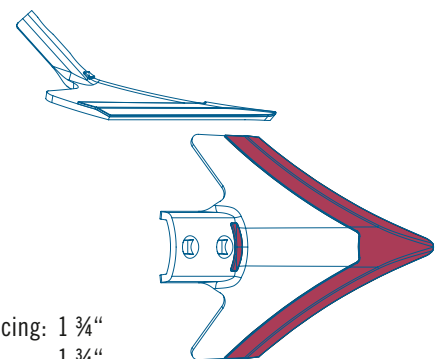
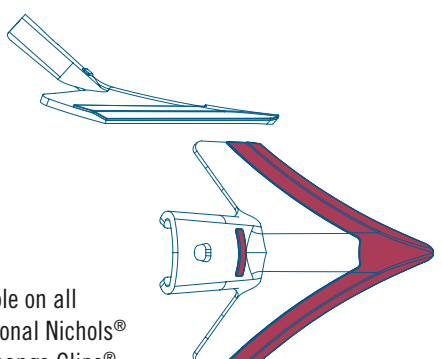
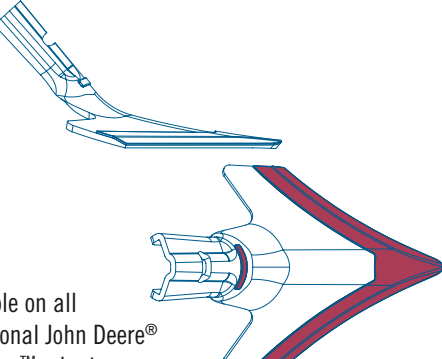

Sweeps

with BusaDUR® wear protection
made of hardened steel

Busatis Part Number	Dimension	Type	Material Thickness	Heavy Duty	Drawing BusaDUR® wear protection marked in red
B1021	7"	bolt-on	¼"	✓	 <p>Hole spacing: 1 ¾" Shank: 1 ¾"</p>
B1024	9"	bolt-on	¼"	✓	
B1022	7"	knock-on	¼"	✓	 <p>Mountable on all conventional Nichols® Quick Change Clips®</p>
B1025	9"	knock-on	¼"	✓	
B1020	7"	knock-on	¼"	✓	 <p>Mountable on all conventional John Deere® Perma-Loc™ adapters</p>
B1023	9"	knock-on	¼"	✓	

John Deere® and Perma-Loc™ are registered trademarks of Deere & Company, which does not manufacture, distribute or endorse these parts.

Nichols® and Nichols Quick Change Clips® are registered trademarks of Nichols Tillage Tools, which does not manufacture, distribute or endorse these parts.



Chisel Point

with BusaDUR® wear protection
made of hardened steel



- ▶ Hole spacing: 2¼ - 2½"
- ▶ Bolt Size: Standard ½" or M12 Hex Bolt
- ▶ Nose Style: V Point

- ▶ Thickness: 1"
- ▶ Width: 2 1/6"
- ▶ Length: 18"

Standard

BusaDUR® wear protection
(marked in red)

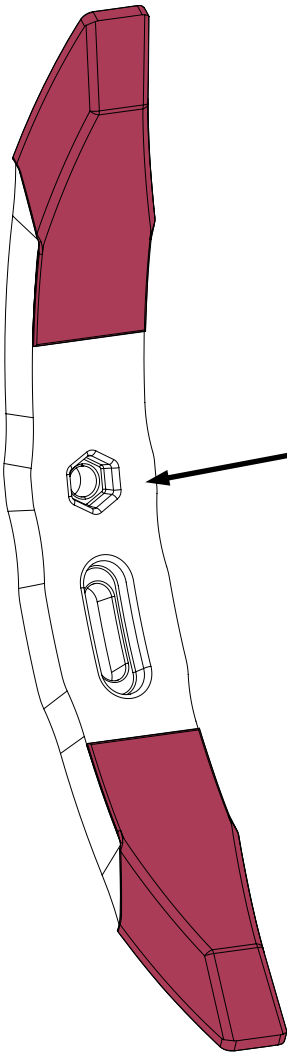

Heavy Duty

BusaDUR® wear protection
(marked in red)
additional Carbide Insert

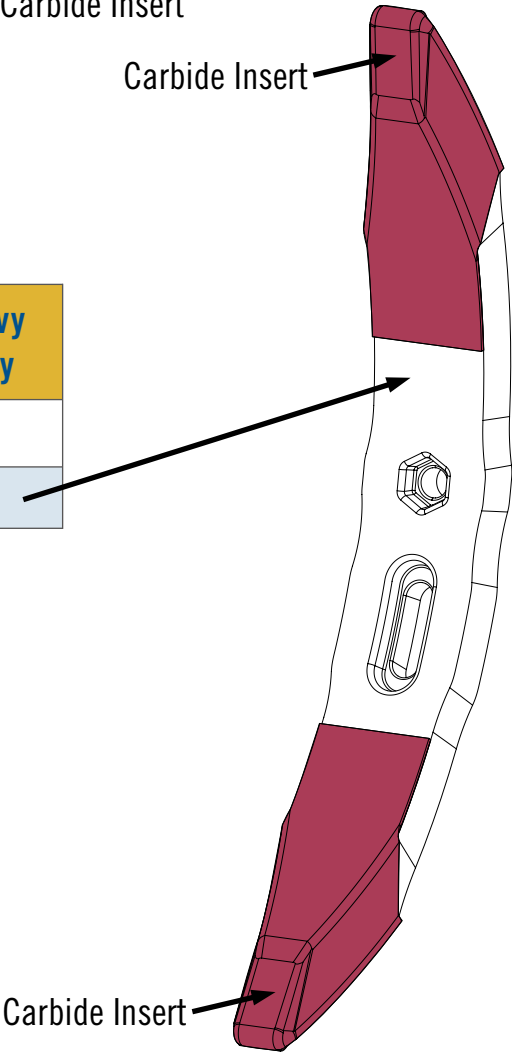

Busatis Part Number	Type	Heavy Duty
B1026	bolt-on	
B1019	bolt-on	✓